

## PREMIUM LIST

**EARLY ENTRIES CLOSE, WEDNESDAY, JANUARY 10, 2018 at 6pm**

at 1636 AIRLINE GOLDMINE ROAD, CANON, GA 30520

**DAY OF TRIAL ENTRIES CLOSE, SATURDAY, JANUARY 13, 2018 at 8am**

at the Field Trial Secretary's Table

### Directions to The Polo Field, Camden, SC

From the North: Follow 97/521/601 into Camden. Where it becomes Broad Street, after you pass the railroad tracks, turn Right onto Polo Lane. Follow Polo Lane to the field. Polo Lane is a very narrow street (about 1 car width). Watch for signs.

From the South: On Interstate-20 in South Carolina take Exit 92 onto US-601 North toward Camden. Travel about 5.5 miles, and turn LEFT onto 601 North Truck/Springdale Dr (first traffic light past Wal-Mart). On 601 North Truck, travel past Springdale racecourse to the Hwy 97. Turn Right onto Hwy 97. Hwy 97 blends into Broad Street. On Broad Street, after you pass the railroad tracks, turn Right onto Polo Lane. Follow Polo Lane to the field. Polo Lane is a very narrow street (about 1 car width). Watch for signs.



Region 7

**CAROLINA LURE COURSING SOCIETY  
ASFA ALL-BREED FIELD TRIALS**

**“JANUARY JAM”**

**Stewart Holcomb Memorial Trophy**

**Saturday, January 13, 2018**

**Sunday, January 14, 2018**

**CAMDEN POLO FIELD**

**Polo Lane**

**Camden, South Carolina**

**EARLY ENTRY FEES: \$20.00 for first hound entered,  
\$15.00 for the second hound entered (same owner/household)  
\$12.00 for each additional hound entered (same owner/household)**

**DAY OF ENTRY FEES: \$30.00 PER HOUND!!**

**CLCS will NOT hold checks!**

Permission has been granted by the American Sighthound Field Association for the holding of this event under ASFA Rules and Regulations.

Audrey Silverstein, ASFA Scheduling Chair

---

Go to [www.ASFA.org](http://www.ASFA.org)

for online Rulebook, Policies, Contacts, Clubs,  
Trial Schedules, Trial Results & much more.

## CAROLINA LURE COURSING SOCIETY

President: Donna Richards Vice President: Kasey Parks  
Treasurer: Judith Brown Secretary: xxxxxxx

### JUDGES & ASSIGNMENTS

Don Ewing Littlestown, PA  
Donna Richards Denver, NC  
Sandra Moore Quebeck, TN  
S = Single Judge \* = Provisional Judge

#### SATURDAY

JUDGE	A	Az	Ba	B	C	G	Ib	Iw	IG	P	R	S	SD	SI	SW	W	Sgl	Ltd
Don	S	S	S	S	S	S	S	S	S	S	S	S	S	S	S	S	S	S

#### SUNDAY

JUDGE	A	Az	Ba	B	C	G	Ib	Iw	IG	P	R	S	SD	SI	SW	W	Sgl	Ltd
Don	X	X	X	X	X	X	X	X	X	X	X	X	X	X	X		X	X
Sandra	X	X	X		X	X	X	X	X	X	X	X	X	X	X	S	X	X
Donna				X														

#### FIELD COMMITTEE

Field Trial Chairman: Dale Parks, Canon, GA  
Field Trial Secretary: Kasey Parks,  
1636 AIRLINE GOLDMINE ROAD, CANON, GA 30520  
706-371-9512 (text or leave message) - kckennels@outlook.com  
Lure Operators: Dale Parks, Donna Richards

TRIAL HOURS: 8:00 a.m. UNTIL AFTER RIBBONS ARE AWARDED.

Day of Trial entries close at 8:00 a.m.

Substitutions (same owner) until Saturday, 8:00 a.m.

ROLL CALL: PROMPTLY at 8:30 a.m.

ENTRIES WILL NOT BE ACKNOWLEDGED BY RETURN MAIL OR PHONE;

ENTRIES MAY BE ACKNOWLEDGED BY E-MAIL

IF OWNER FORWARDS E-MAIL ADDRESS.

**Ribbons or rosettes will be offered for all placements.**

First=Blue, Second=Red, Third=Yellow, Fourth=White, NBQ=Green

Highest Scoring Single=Navy/Gold, Best of Breed=Purple/Gold,  
& Best in Event=Red, White & Blue.

Please help keep our Polo Field clean. **Please clean up after your dog!**  
We all know the local neighborhood dogs poop on this field, but it is our dogs that get blamed for it. Please be kind and pick up ALL poop you see. We do not want to lose this field. **NO POOP BAGS IN PORTA POTTIES!!**

Please bring your own water and shade.

Remember to bring sunscreen, and warm clothes for yourself and hounds.

Visit us: [www.carolinacoursing.com](http://www.carolinacoursing.com)

## ELIGIBLE BREEDS & REGISTRY

Only purebred Afghan Hounds, Azawakhs, Basenjis, Borzoi, Cirneco dell'Etna, Greyhounds, Ibizan Hounds, Irish Wolfhounds, Italian Greyhounds, Pharaoh Hounds, Rhodesian Ridgebacks, Salukis, Scottish Deerhounds, Sloughis, Silken Windhounds, and Whippets may be entered in the regular stakes.

Limited breeds may be entered in the Limited Stake or the Singles Stake. Limited breeds currently include purebred Chart Polski, Galgo Español, Magyar Agar, Peruvian Inca Orchid, Portuguese Podengo (Pequeno), Portuguese Podengo (Medio & Grande), and must be individually registered with the appropriate registry.

All entries shall be individually registered with the AKC (ILP/PAL included), the NGA, the UKC, the FCI, an ASFA-recognized foreign or ASFA Board approved registry, or possess a CRN from the SPDBS. A photocopy of acceptable registry must be submitted with each hound's first ASFA field trial entry; this requirement is waived for hounds registered with the NGA.

### REGULAR STAKES OFFERED

**OPEN STAKE:** Any eligible sighthound, excluding ASFA Field Champions of record, that have met the certification requirements.

**FIELD CHAMPION STAKE:** Any ASFA Field Champion

**VETERAN STAKE:** Any eligible hound whose age is at least six years, except Irish Wolfhounds whose age shall be at least five years, and Afghan Hounds, Rhodesian Ridgebacks, Salukis and Whippets whose age shall be at least seven years. Points go toward V-Fch or V-LCM titles.

**LIMITED STAKE:** Any eligible sighthound of a Limited breed that has met certification requirements. Not eligible to compete in Best of Breed or Best in Field.

**SINGLE STAKE:** Any eligible sighthound including those disqualified to run in other stakes. Each hound runs alone. Not eligible for Best of Breed or Best in Field. Hounds are eligible to earn TCP and CPX titles from the Singles stake. Limited breeds are not eligible for these titles.

### BEST IN FIELD WILL NOT BE OFFERED

**BEST IN EVENT WILL BE OFFERED. Best of Breed winners from both days may compete for Best In Event on Sunday, "Stewart Holcomb Memorial Trophy".**

**Conditions of Entry:** All entries must be one year or older on the day of the trial • Stakes will be split into flights by public random draw if the entry in any regular stake is 20 or more • Bitches in season, lame hounds and hounds with breed disqualifications will be excused at roll call. • Spayed, neutered, monorchid or cryptorchid hounds without breed disqualifications may be entered; hounds with breed disqualifications are not eligible to enter except in the Single Stake • Hounds not present at the time of roll call will be scratched • All hounds will run twice, in trios if possible or braces (except in the Single Stake), unless excused, dismissed or disqualified.

**Equipment:** Type of lure machine: battery-powered continuous-loop system. • Type of lures: highly-visible white plastic strips • Back-up equipment will be available.

Only the Lure Operator, Huntmaster, Judges and Handlers of the hounds running in the course in progress will be permitted near the lure machine. The members of Carolina Lure Coursing Society reserve the right to alter the course plan as required by weather and/or field conditions on the day of the trial. The field will be reversed for finals, runoffs, Best or Breed and Best In Event.

Children must be under control of their Parent(s) or Guardians(s) at all times.

There will be a \$10.00 fine for any loose dog that disrupts a course in progress.

Practice will be offered (weather, equipment and time permitting) after completion of the trial on Saturday only.

\$3.00 per dog. **No practice on Sunday.**

**COURSE PLANS**  
**Saturday 776 Yards**

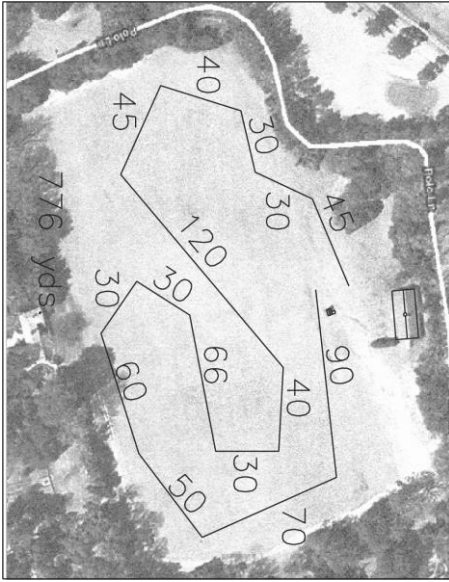

**Sunday 735 Yards**

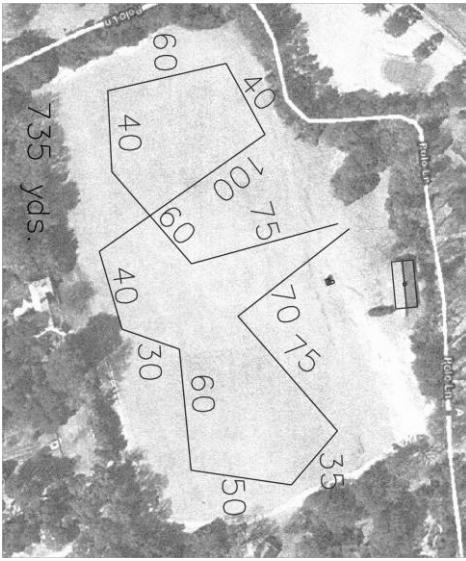

**ON CALL VETERINARIAN**

Camden Emergency Vet . . . . . 803-726-3891  
 South Carolina Veterinary Emergency Care  
 (State of the art — Located in Columbia, SC) . . . . . 803-798-3837

**EMERGENCY MEDICAL**

Camden Regional Hospital, 2871 Main St., Camden, SC . . . . .803-487-1222  
 Camden EMT, Camden Local Fire Dept., Camden City Police 911

**HOTEL ACCOMODATIONS**

Located in/near Camden. **PLEASE CALL AND CONFIRM PET FEES AND IF PETS ARE EVEN STILL ALLOWED.** We are hearing about changes.

- Colony Inn 803-432-5508
- Knights Inn 803-432-2453
- Days Inn 803-438-6990
- Best Western 803-438-9441

**CAMPING**

Camping is allowed on the Field.  
 There are **NO ELECTRICAL HOOK UPS**. There is no power on the field.

Columbia Camden RV Park, Lugoff, SC 803-438-8774

**PLEASE CLEAN UP AFTER YOUR  
 HOUNDS!!!!  
 NO POOP IN PORTA POTTIES**

**PLEASE TAKE YOUR GARBAGE WITH  
 YOU WHEN YOU LEAVE!!!**

**OFFICIAL AMERICAN SIGHTHOUND FIELD ASSOCIATION ENTRY FORM  
CAROLINA LURE COURSING SOCIETY**

**SATURDAY, JANUARY 13, 2018**

Early entries close **Wednesday, January 10, 2018 at 6pm** at the FTS's residence.

Early entry fees: **\$20.00 first hound/\$15.00 second hound**

**\$12.00 each additional hound same owner - Day of trial entry fee: \$30.00 Per Dog**

(Substitutions, same owner, until Saturday, January 13, 2018, 8:00 am)

Make checks payable (in US funds) to **CLCS** and mail to:

**Kasey Parks – FTS • 1636 Airline Goldmine Road, Canon, GA 30520**

Fee Paid \_\_\_\_\_ The Field Secretary cannot accept conditional, unsigned, incomplete or unpaid entries; please check your completed entry carefully.

Breed:		Call Name:	
Registered Name of Hound:			
Stake: <input type="checkbox"/> Open <input type="checkbox"/> FCH <input type="checkbox"/> Veteran <input type="checkbox"/> Single <input type="checkbox"/> Limited		Additional Stakes <input type="checkbox"/> Kennel <input type="checkbox"/> Breeder <input type="checkbox"/> Bench	
Registration Number: (please write in registering body before number)			
<input type="checkbox"/> If possible, please separate my hounds	Date of Birth:	Sex: <input type="checkbox"/> Dog <input type="checkbox"/> Bitch	
Name of actual owner(s):			
Address:		Phone:	
City:	State:	Zip:	
E-mail (Optional)		(Optional) Region of Residence:	
Emergency Contact Name and Phone (Optional)			
<input type="checkbox"/> Check if this is the first ASFA trial for this hound. Attach a Hound Certification or waiver if entered in Open, Veterans, Limited.			
<input type="checkbox"/> Check if this is a first-time entry, a copy of the official Registration of this hound must accompany this entry unless NGA.			
<input type="checkbox"/> Check if any information has changed since the last ASFA trial entry. Regarding _____			
<input type="checkbox"/> Check if this hound has been dismissed within the last 6 trials entered. Must be marked in order to qualify for a "clean" trial requirement.			

I CERTIFY that I am the actual owner of this dog, or that I am the duly authorized agent of the actual owner whose name I have entered above. In consideration of the acceptance of this entry and the opportunity to have this dog judged and to win prize money, ribbons, or trophies, I (we) agree to abide by the rules and regulations of the American Sighthound Field Association in effect at the time of this lure field trial, and by any additional rules and regulations appearing in the premium list for this lure field trial. I (we) agree that the club holding this lure field trial has the right to refuse this entry for cause, which the club shall deem to be sufficient. I (we) agree to hold this club, its members, directors, governors, officers, agents or other functionaries, any employees of the aforementioned parties and the owner(s) of the trial premises or grounds harmless from any claim for loss or injury which may be alleged to have been caused directly or indirectly to any person or thing by the act of this dog while in or upon the lure field trial premises or grounds or near any entrance thereto and I (we) personally assume all responsibility and liability for any such claim, and I (we) further agree to hold the aforementioned parties harmless from any claim loss of this dog by disappearance, theft damage or injury be caused or alleged to be caused by the negligence of the club or any of the aforementioned parties or by the negligence of any person or any other cause or causes. I (we) certify and represent that the dog entered is not a hazard to person or other dogs. This entry is submitted for acceptance of the forgoing representations and agreements.

**SIGNATURE** of owner or his agent  
duly authorized to make this entry \_\_\_\_\_

**Please separate the entries before submitting to FTS.**

**OFFICIAL AMERICAN SIGHTHOUND FIELD ASSOCIATION ENTRY FORM  
CAROLINA LURE COURSING SOCIETY**

**SUNDAY, JANUARY 14, 2018**

Early entries close **Wednesday, January 10, 2018 at 6pm** at the FTS's residence.

Early entry fees: **\$20.00 first hound/\$15.00 second hound**

**\$12.00 each additional hound same owner - Day of trial entry fee: \$30.00 Per Dog**

(Substitutions, same owner, until Saturday, January 13, 2018, 8:00 am)

Make checks payable (in US funds) to **CLCS** and mail to:

**Kasey Parks – FTS • 1636 Airline Goldmine Road, Canon, GA 30520**

Fee Paid \_\_\_\_\_ The Field Secretary cannot accept conditional, unsigned, incomplete or unpaid entries; please check your completed entry carefully.

Breed:		Call Name:	
Registered Name of Hound:			
Stake: <input type="checkbox"/> Open <input type="checkbox"/> FCH <input type="checkbox"/> Veteran <input type="checkbox"/> Single <input type="checkbox"/> Limited		Additional Stakes <input type="checkbox"/> Kennel <input type="checkbox"/> Breeder <input type="checkbox"/> Bench	
Registration Number: (please write in registering body before number)			
<input type="checkbox"/> If possible, please separate my hounds	Date of Birth:	Sex: <input type="checkbox"/> Dog <input type="checkbox"/> Bitch	
Name of actual owner(s):			
Address:		Phone:	
City:	State:	Zip:	
E-mail (Optional)		(Optional) Region of Residence:	
Emergency Contact Name and Phone (Optional)			
<input type="checkbox"/> Check if this is the first ASFA trial for this hound. Attach a Hound Certification or waiver if entered in Open, Veterans, Limited.			
<input type="checkbox"/> Check if this is a first-time entry, a copy of the official Registration of this hound must accompany this entry unless NGA.			
<input type="checkbox"/> Check if any information has changed since the last ASFA trial entry. Regarding _____			
<input type="checkbox"/> Check if this hound has been dismissed within the last 6 trials entered. Must be marked in order to qualify for a "clean" trial requirement.			

I CERTIFY that I am the actual owner of this dog, or that I am the duly authorized agent of the actual owner whose name I have entered above. In consideration of the acceptance of this entry and the opportunity to have this dog judged and to win prize money, ribbons, or trophies, I (we) agree to abide by the rules and regulations of the American Sighthound Field Association in effect at the time of this lure field trial, and by any additional rules and regulations appearing in the premium list for this lure field trial. I (we) agree that the club holding this lure field trial has the right to refuse this entry for cause, which the club shall deem to be sufficient. I (we) agree to hold this club, its members, directors, governors, officers, agents or other functionaries, any employees of the aforementioned parties and the owner(s) of the trial premises or grounds harmless from any claim for loss or injury which may be alleged to have been caused directly or indirectly to any person or thing by the act of this dog while in or upon the lure field trial premises or grounds or near any entrance thereto and I (we) personally assume all responsibility and liability for any such claim, and I (we) further agree to hold the aforementioned parties harmless from any claim loss of this dog by disappearance, theft damage or injury be caused or alleged to be caused by the negligence of the club or any of the aforementioned parties or by the negligence of any person or any other cause or causes. I (we) certify and represent that the dog entered is not a hazard to person or other dogs. This entry is submitted for acceptance of the forgoing representations and agreements.

**SIGNATURE** of owner or his agent  
duly authorized to make this entry \_\_\_\_\_

**Please separate the entries before submitting to FTS.**

**AMERICAN SIGHTHOUND FIELD ASSOCIATION  
HOUND CERTIFICATION**

**Rule effective October 1, 1994: Ch. V, Sec. 4 (a) OPEN STAKE:** *To be eligible to enter the open stake, a hound must have been certified by a licensed judge within the year preceding the closing date for the entry or have previously competed in the Open Stake. This eligibility requirement also applies to a hound entered in the Limited or Veteran Stake, which has not competed in Open previously. Please complete this portion of this form and attach it to the entry form for the hound's first entry, including an entry for a Fun Trial.*

Registered Name of Hound: \_\_\_\_\_

Registration Number: \_\_\_\_\_ Breed: \_\_\_\_\_

Registered Owner's Name: \_\_\_\_\_

I hereby certify that on (date) \_\_\_\_\_, the above named hound completed a lure course of at least 500 yards, running with another hound of the same breed (or another breed with a similar running style). During the course the above named hound showed no inclination to interfere with the other hound. I further certify that I am a licensed judge for the ASFA.

Name of Licensed Judge: \_\_\_\_\_

Signature: \_\_\_\_\_ Date: \_\_\_\_\_

I hereby certify that the hound running in the certification course is the hound identified above and that information provided on this form is true and correct.

Signature: \_\_\_\_\_ Date: \_\_\_\_\_

Owner or Authorized Agent of Hound

This certification form must be attached to the entry form the first time this hound is entered in an open, limited, or veteran stake. Any hound entered in open, limited, or veteran (as a first time entered hound), which has not been certified, shall be declared ineligible by the records coordinator and shall forfeit any points and placements awarded.

**PLEASE RETAIN A COPY FOR YOUR RECORDS.**

**AMERICAN SIGHTHOUND FIELD ASSOCIATION  
HOUND CERTIFICATION WAIVER**

**Waiver of Requirement:** *This requirement will be waived for a hound that has earned a lure coursing or racing title from another recognized organization, if such title requires competition, and if a waiver for such title has been approved by the ASFA, or a CKC Hound Certification Form. If your hound qualifies for a waiver, complete this portion of this form and attach it to your entry form. Proof of waivers must accompany this certification form.*

Registered Name of Hound: \_\_\_\_\_

Registration Number: \_\_\_\_\_ Breed: \_\_\_\_\_

Registered Owner's Name: \_\_\_\_\_

**CKC:** FCH FCHX      **CWA:** ARX TRP SRA DPC  
**AKC:** QC SC FC      **LGRA:** GRC **NAWRA:** RCH SR  
**WRA:** CR WRCH      **NOTRA:** ORC OTR SORC SOR

Hound Certification previously submitted.

I hereby certify that the hound identified above has completed the requirements for the title indicated above (or that the required Certification was previously submitted) and that the information provided on this form is true and correct.

Signature: \_\_\_\_\_ Date: \_\_\_\_\_

Owner or Authorized Agent of Hound

**AMERICAN SIGHTHOUND FIELD ASSOCIATION  
HOUND CERTIFICATION**

**Rule effective October 1, 1994: Ch. V, Sec. 4 (a) OPEN STAKE:** *To be eligible to enter the open stake, a hound must have been certified by a licensed judge within the year preceding the closing date for the entry or have previously competed in the Open Stake. This eligibility requirement also applies to a hound entered in the Limited or Veteran Stake, which has not competed in Open previously. Please complete this portion of this form and attach it to the entry form for the hound's first entry, including an entry for a Fun Trial.*

Registered Name of Hound: \_\_\_\_\_

Registration Number: \_\_\_\_\_ Breed: \_\_\_\_\_

Registered Owner's Name: \_\_\_\_\_

I hereby certify that on (date) \_\_\_\_\_, the above named hound completed a lure course of at least 500 yards, running with another hound of the same breed (or another breed with a similar running style). During the course the above named hound showed no inclination to interfere with the other hound. I further certify that I am a licensed judge for the ASFA.

Name of Licensed Judge: \_\_\_\_\_

Signature: \_\_\_\_\_ Date: \_\_\_\_\_

I hereby certify that the hound running in the certification course is the hound identified above and that information provided on this form is true and correct.

Signature: \_\_\_\_\_ Date: \_\_\_\_\_

Owner or Authorized Agent of Hound

This certification form must be attached to the entry form the first time this hound is entered in an open, limited, or veteran stake. Any hound entered in open, limited, or veteran (as a first time entered hound), which has not been certified, shall be declared ineligible by the records coordinator and shall forfeit any points and placements awarded.

**PLEASE RETAIN A COPY FOR YOUR RECORDS.**

**AMERICAN SIGHTHOUND FIELD ASSOCIATION  
HOUND CERTIFICATION WAIVER**

**Waiver of Requirement:** *This requirement will be waived for a hound that has earned a lure coursing or racing title from another recognized organization, if such title requires competition, and if a waiver for such title has been approved by the ASFA, or a CKC Hound Certification Form. If your hound qualifies for a waiver, complete this portion of this form and attach it to your entry form. Proof of waivers must accompany this certification form.*

Registered Name of Hound: \_\_\_\_\_

Registration Number: \_\_\_\_\_ Breed: \_\_\_\_\_

Registered Owner's Name: \_\_\_\_\_

**CKC:** FCH FCHX      **CWA:** ARX TRP SRA DPC  
**AKC:** QC SC FC      **LGRA:** GRC **NAWRA:** RCH SR  
**WRA:** CR WRCH      **NOTRA:** ORC OTR SORC SOR

Hound Certification previously submitted.

I hereby certify that the hound identified above has completed the requirements for the title indicated above (or that the required Certification was previously submitted) and that the information provided on this form is true and correct.

Signature: \_\_\_\_\_ Date: \_\_\_\_\_

Owner or Authorized Agent of Hound